

**Junction Name:-** Pankha Rd. A1 Cut  
Janakpuri

**Jn. Code:-** G-19  
**District :-** South West  
**Circle :-** Tilak Nagar

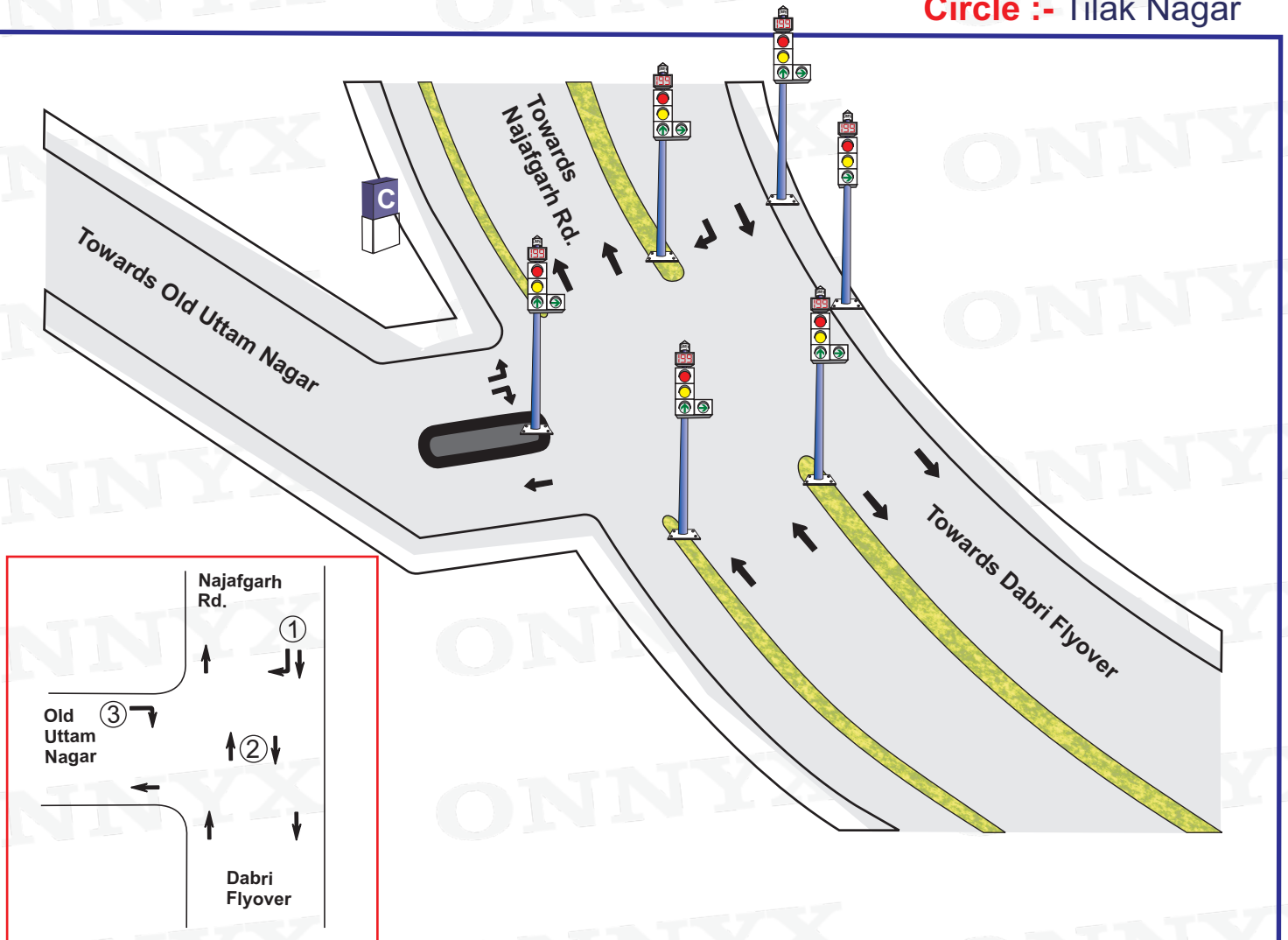

Plan No.	Time	①	②	③	Total Cycle Time
1.	06:00-08:00	16 Sec.	21 Sec.	16 Sec.	63 Sec.
2.	08:00-12:00	26 Sec.	41 Sec.	21 Sec.	88 Sec.
3.	12:00-17:00	21 Sec.	36 Sec.	21 Sec.	78 Sec.
4.	17:00-23:00	26 Sec.	41 Sec.	21 Sec.	88 Sec.
Non Working day & Public Holiday	06:00-11:00	16 Sec.	21 Sec.	16 Sec.	63 Sec.
	11:00-23:00	21 Sec.	36 Sec.	21 Sec.	78 Sec.

04 Sec. included in all Phases for AMBER

**Signal Timing – 06:00--23:00**

**Blinker Timing – 23:00--06:00**

**Not to scale**

Prepared by : [www.onnyx.in](http://www.onnyx.in)