

Junction Name:- Sec. - 8,9 R. K. Puram
RTR Marg

Jn. Code:- I-33
District :- South
Circle :- R. K. Puram

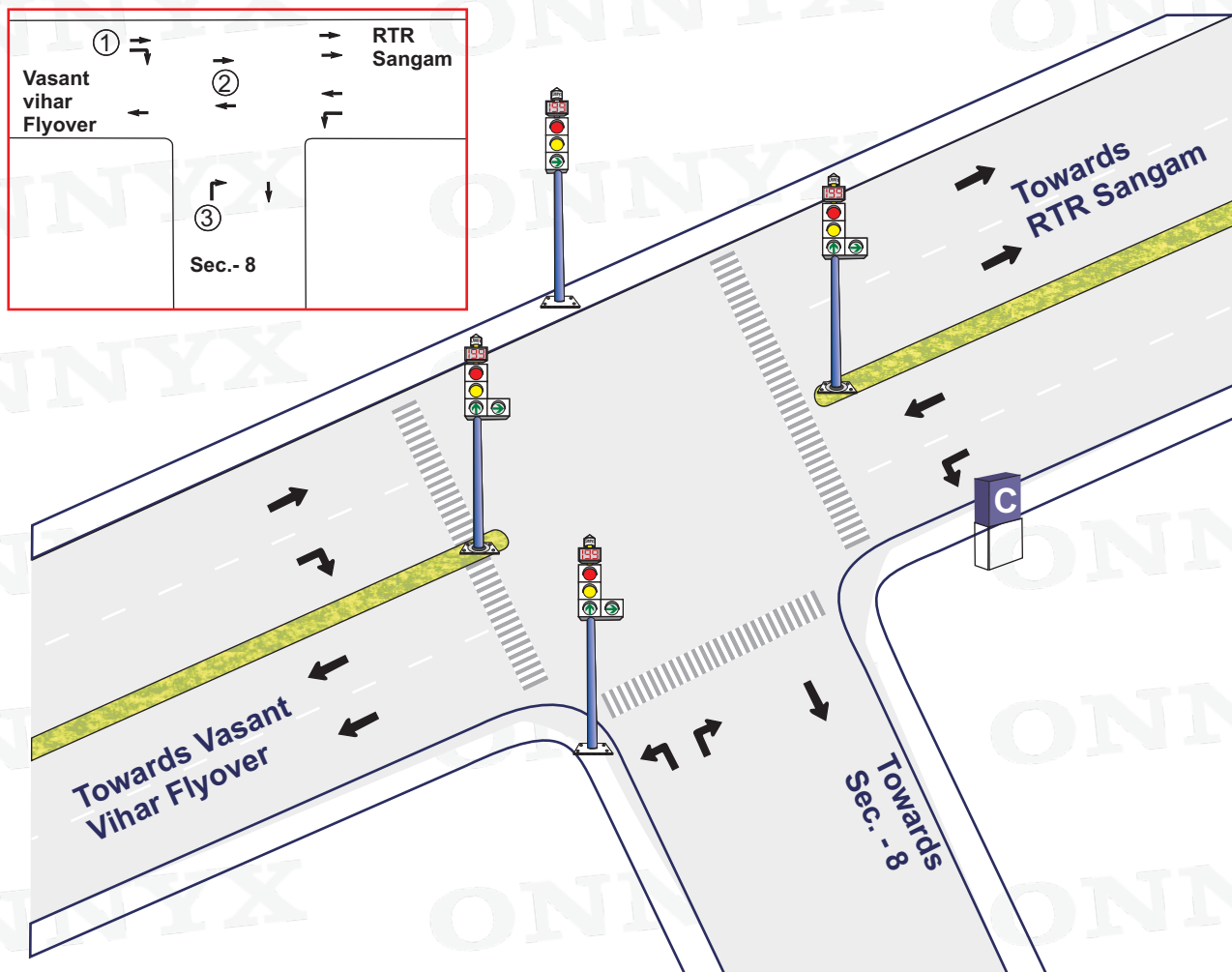

| Plan No. | Time | ① | ② | ③ | Total Cycle Time |
|----------|-------------|---------|---------|---------|------------------|
| 1. | 06:00-08:00 | 15 Sec. | 20 Sec. | 15 Sec. | 50 Sec. |
| 2. | 08:00-16:00 | 40 Sec. | 65 Sec. | 30 Sec. | 135 Sec. |
| 3. | 16:00-22:00 | 45 Sec. | 70 Sec. | 30 Sec. | 145 Sec. |
| 4. | 22:00-23:00 | 25 Sec. | 20 Sec. | 15 Sec. | 60 Sec. |

05 Sec. included in all Phases for AMBER

Signal Timing – 06:00 – 23:00

Blinker Timing – 23:00 – 06:00

Not to scale

Prepared by : www.onnyx.in