

**Junction Name:-** Ayodhya Chowk

**Jn. Code:-** B-76

**District :-** North West

**Circle :-** Rohini

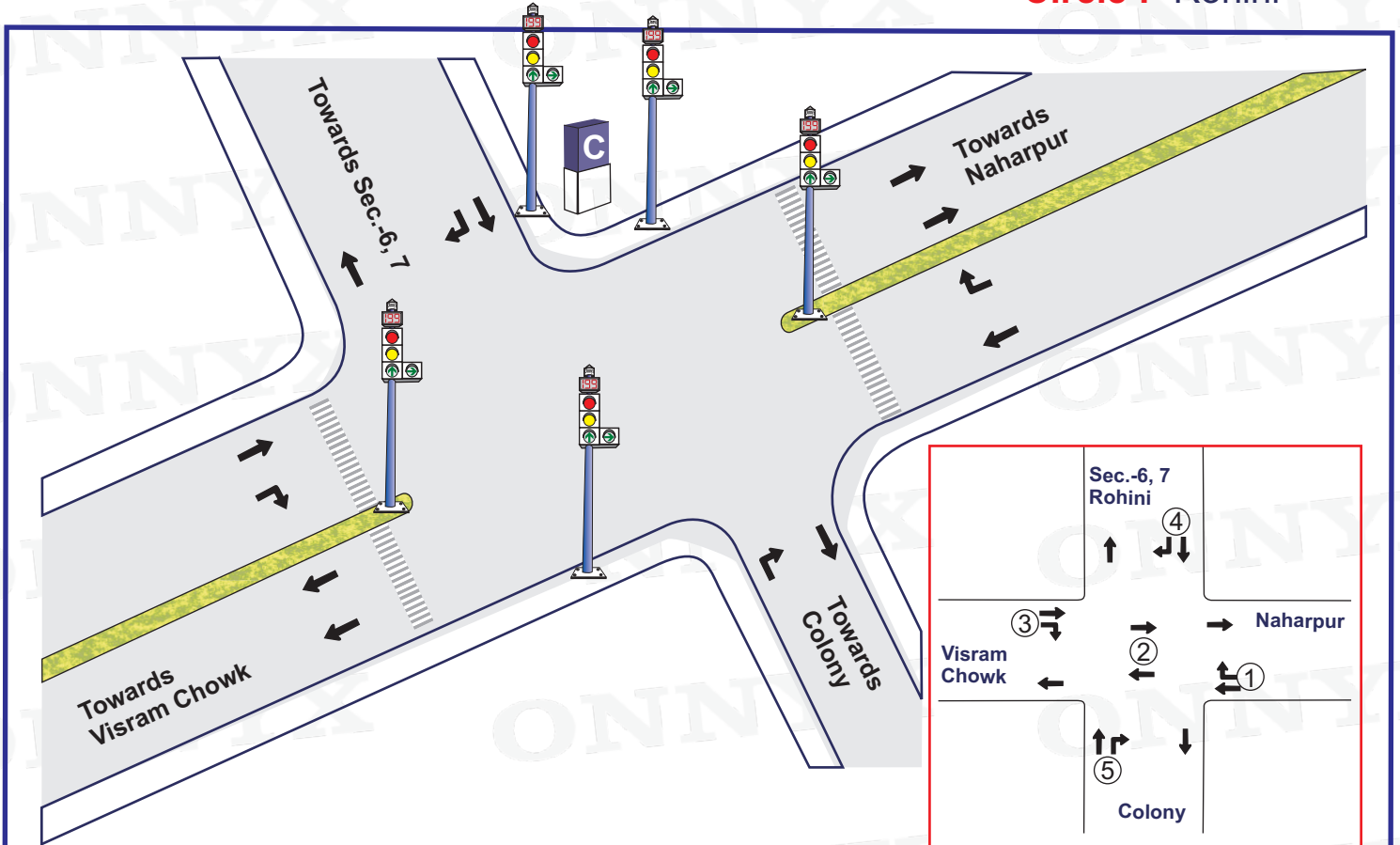

Plan No.	Time	①	②	③	④	⑤	Total Cycle Time
1.	06:00-23:00	25 Sec.	40 Sec.	25 Sec.	30 Sec.	15 Sec.	135 Sec.

05 Sec. included in all Phases for AMBER

**Signal Timing – 06:00 – 23:00**

**Blinker Timing – 23:00 – 06:00**

Not to scale

Prepared by : [www.onnyx.in](http://www.onnyx.in)