

Junction Name:- Shayamnath Marg Rajniwas Marg

Jn. Code:- S-19
District :- North
Circle :- Civil Line

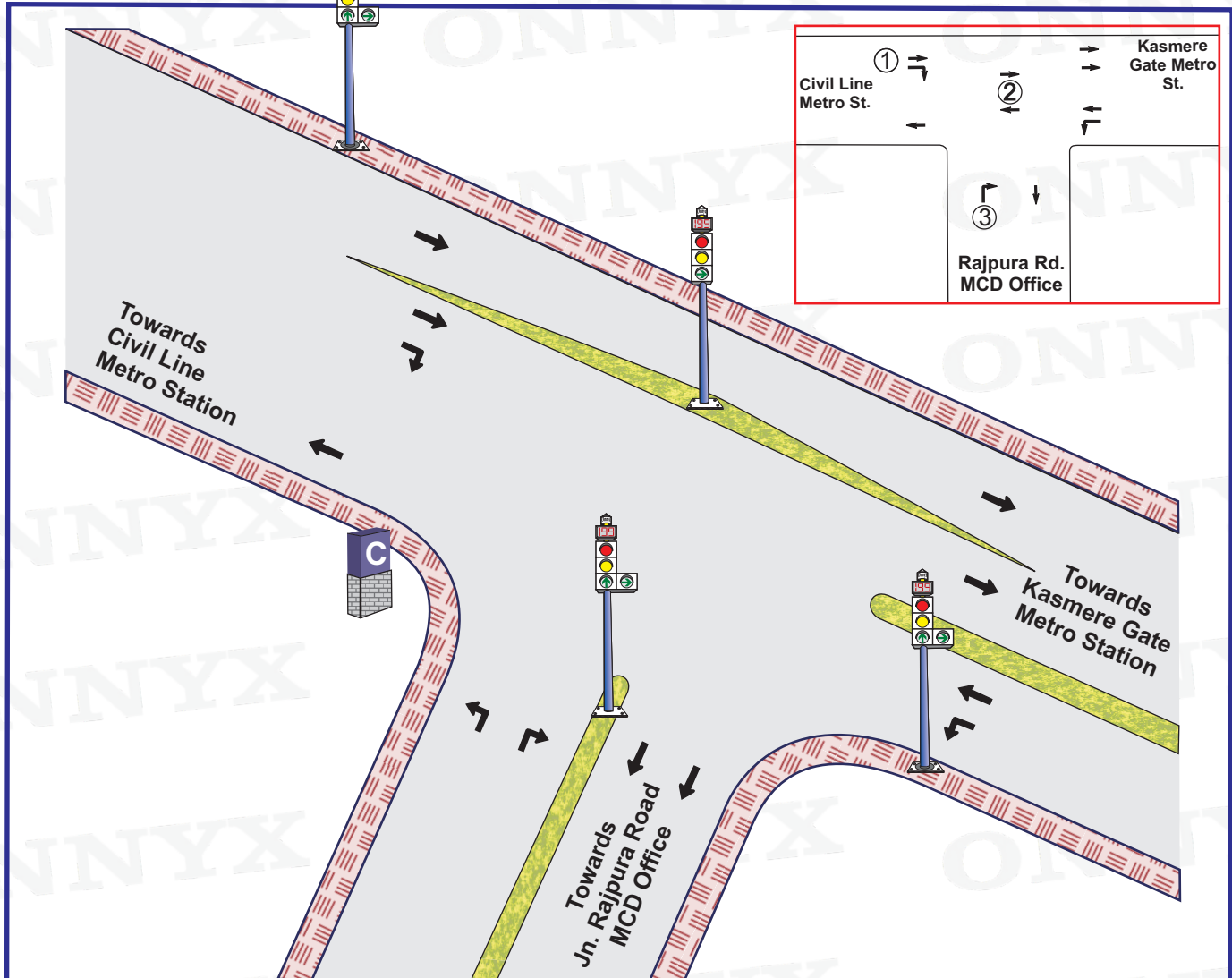

Plan No.	Time	①	②	③	Total Cycle Time
1.	06:00-08:00	15 Sec.	25 Sec.	15 Sec.	55 Sec.
2.	08:00-09:00	15 Sec.	30 Sec.	15 Sec.	60 Sec.
3.	09:00-11:00	20 Sec.	35 Sec.	20 Sec.	75 Sec.
4.	11:00-17:00	20 Sec.	35 Sec.	15 Sec.	70 Sec.
5.	17:00-20:00	20 Sec.	40 Sec.	20 Sec.	80 Sec.
6.	20:00-21:00	15 Sec.	30 Sec.	15 Sec.	60 Sec.
7.	21:00-22:00	15 Sec.	25 Sec.	15 Sec.	55 Sec.

05 Sec. included in all Phases for AMBER

Signal Timing – 06:00--22:00

Blinker Timing – 22:00 – 06:00

Not to scale

Prepared by : www.onnyx.in